

OPERATING LIMITS

Capacities up to:	65 m ³ /h
Heads up to:	9 m
Max operating pressure:	10 bar
Max ambient temperature:	+ 40°C
Max loop* temperature:	+ 60°C
Water hardness (TH):	35°F
Water/Glycol mixture :	up to 50%**
DN of ports:	40 to 80

* -10 to + 110°C

** in this case, adjust hydraulic performances

SXS

COMMERCIAL GLANDLESS PUMPS

Bronze pump casing
Secondary hot water
2 poles – 50 Hz

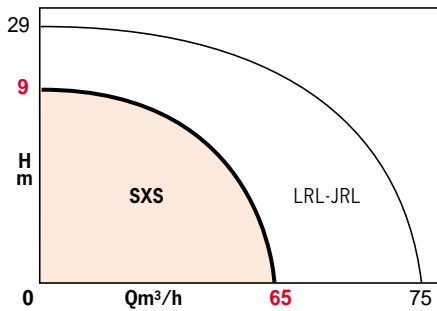

APPLICATIONS

Accelerated water circulation within loops :
 – secondary hot water
 – heating water (according to VDI 2035)
 – instantaneous hot water supplied on demand
 – for non-aggressive, non-corrosive liquids.

- Housing projects.
- Offices.
- Collective buildings.
- Industries.
- Hospitals.
- Hotels, etc.



• SXS 40-40



• SXS 50-50

BENEFITS

- Reliable components
- Mechanical seal insulating the motor housing
- Built-on thermal overload protection motor
- Compact
- Easy installation
- Safe contact of the materials with water: water quality preserved
- Very quiet operation thanks to the integration of all rotating and water contact parts into the motor cartridge
- Choice of operating speed selection (3-speeds motor)
- Automatic venting of circulator
- Maintenance-free

DESIGN

• Pump

Flanged casing, in line ports. Flanges fitted with pressure gauge ports.

• Motor

2-pole – 3-speeds motor.

Wet rotor.

Self-lubricating bearings.

Built-in thermal overload protection

Speeds : see table

Winding 3-phase : 230 - 400 V,

1-phase : 230 V/SXS 40-40M

Frequency : 50 Hz

Insulation class : F

Protection index : IP 42

Conformity :

- EN 61000-6-3

- EN 61000-6-2

- EC

STANDARD CONSTRUCTION

Main components	Material
Pump casing	Bronze
Motor shaft	Stainless steel
Impeller	Composite (reinforced PP/PPS)
Bearings	Resin impregnated carbon

Mechanical seal between pump and motor

PRESELECTION CHART

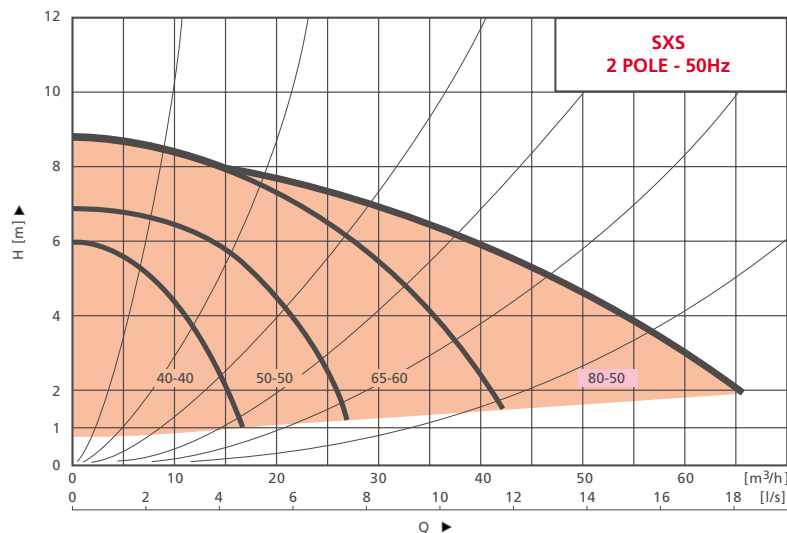

SECTIONAL DRAWING

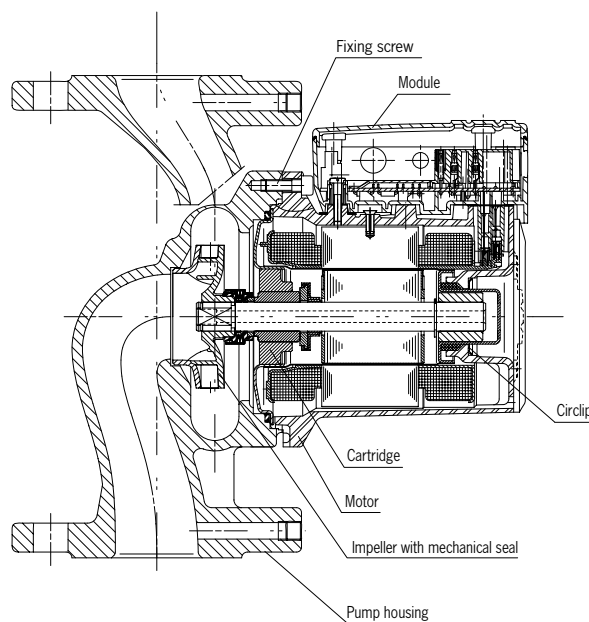

INSTALLATION MODE

Minimum head up (in m CE) upon circulator suction, according to operating temperature.

	+ 40°C	+ 80°C	+110°C
DN 40	5 m	8 m	20 m
DN 50	8 m	10 m	30 m
DN 65	8 m	10 m	30 m
DN 80	8 m	10 m	30 m

FITTING POSITIONS

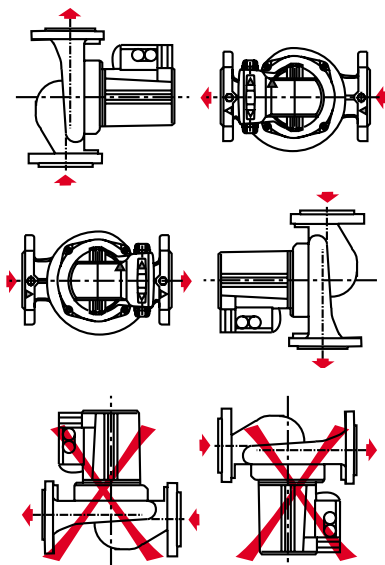

INSTALLATION DIAGRAM

Circulator on loop back circuit, secondary hot water distribution.
(Circuit max temperature = 60°C – DIU standard)

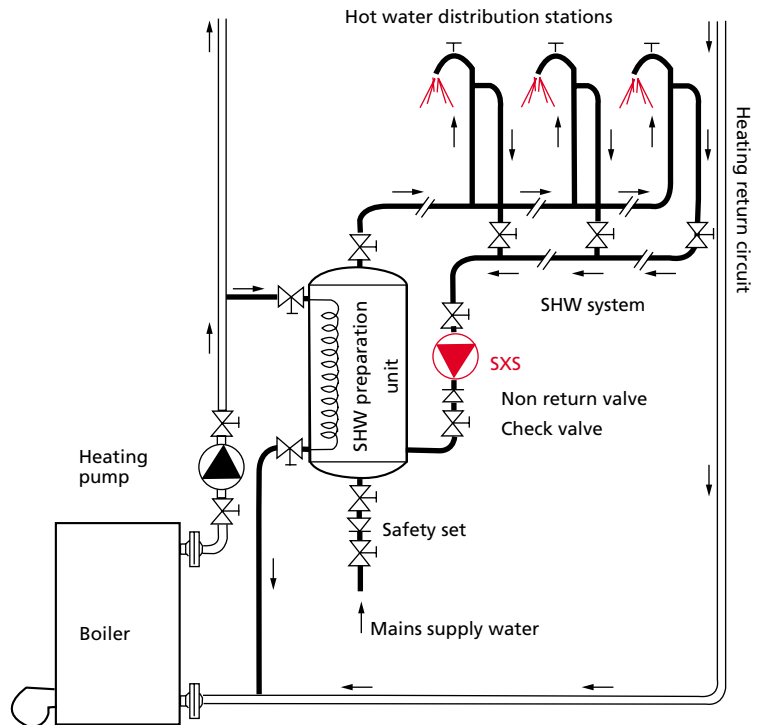

SPEED/VOLTAGE SELECTION

VOLTAGE SELECTION IN THREE-PHASE

Voltage selection is performed by means of an plug-in selector, using the sliding ring :

- Low position for three-phase 400V
 - High position for three-phase 230V
- The circulator is supplied in three-phase 400V.

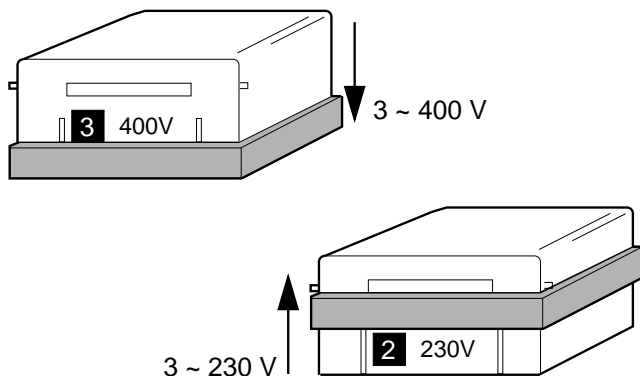

SPEED SELECTION

The circulator's operating speed is coupled with the motor's power supply voltage. The speed selected is visible in the rear window of the terminal box.



HYDRAULIC PERFORMANCE

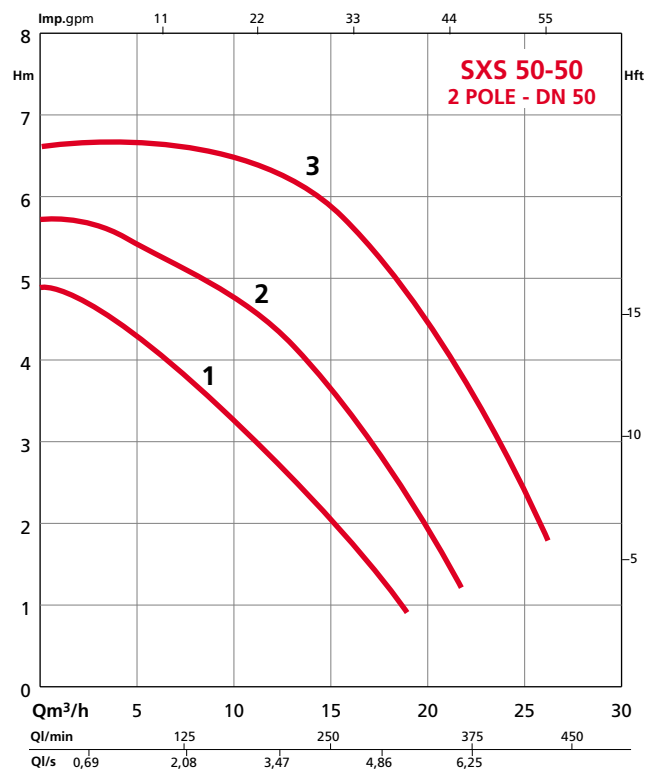
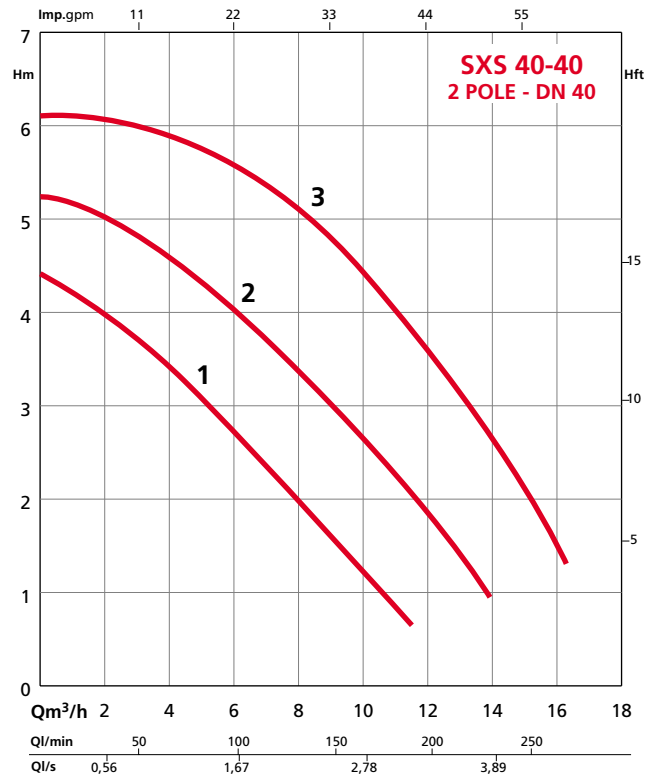
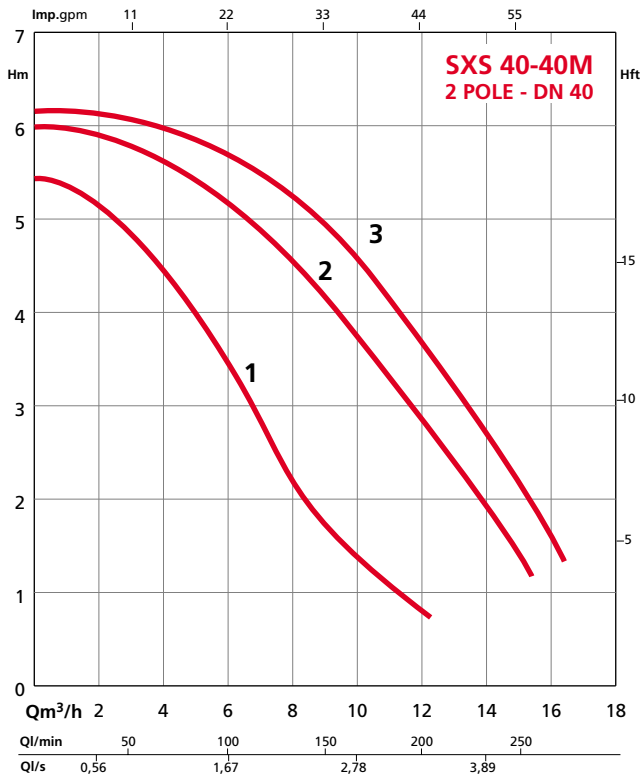

HYDRAULIC PERFORMANCE

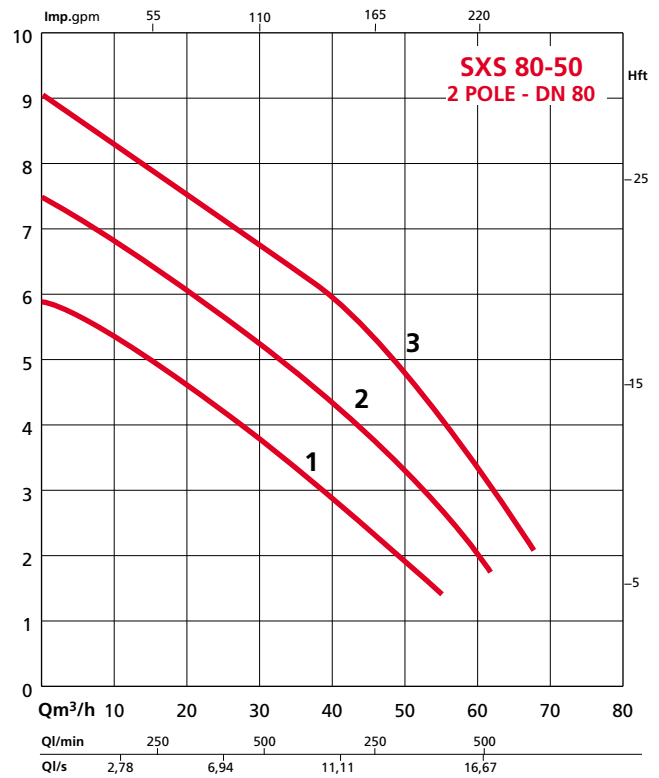
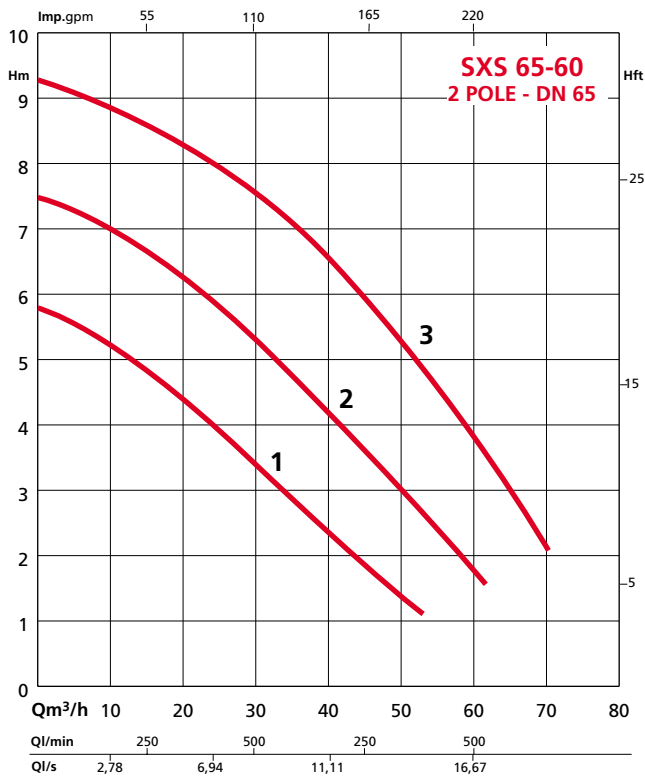

ELECTRICAL DATA

ORDER REFERENCE	Capacitor µF	Position selector	Speed r.p.m.	Rated power P2 max (W)	Power input P1 (W)		Current I. max			Motor Head	Order ref.	
					Min.	Max.	1~230V	3~230V	3~400V			
SXS 40-40M	8 x 400	1	2400	180	175	310	1,54			BMSXS40-40M	2044379	
		2	2600	180	200	330						1,60
		3	2700	180	240	340						1,62
SXS 40-40		1	2000	180	120	180		0,55	0,32	BMSXS40-40	2044375	
		2	2300	180	145	240		0,76	0,44			
		3	2700	180	195	320		1,22	0,70			
SXS 50-50		1	2000	350	240	390		1,19	0,69	BMSXS50-50	2044376	
		2	2300	350	280	520		1,60	0,92			
		3	2700	350	375	680		2,38	1,38			
SXS 65-60		1	2500	700	515	720		2,25	1,30	BMSXS65-60	2044377	
		2	2700	700	580	840		2,68	1,55			
		3	2850	700	760	1050		4,19	2,42			
SXS 80-50		1	2200	1100	865	940		2,91	1,68	BMSXS80-50	2044378	
		2	2500	1100	1055	1155		3,56	2,06			
		3	2800	1100	1290	1440		5,06	2,92			

DIMENSIONS

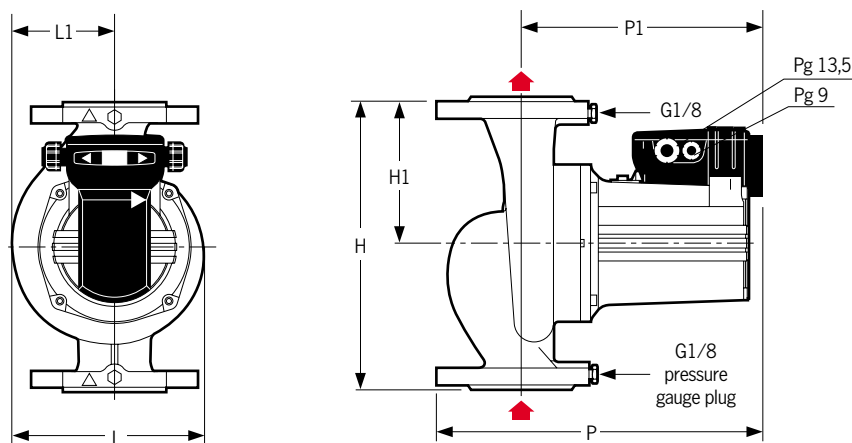

ORDER REFERENCE	DN of ports	L mm	H mm	P mm	L1 mm	H1 mm	P1 mm	Weight kg
SXS 40-40M	40	155	250	269	80	125	194	11
SXS 40-40	40	155	250	269	80	125	194	11
SXS 50-50	50	174	280	308	91	140	225	16
SXS 65-60	65	218	340	349	118	170	256	25,5
SXS 80-50	80	244	360	358	135	180	258	30

Flange PN 16 - EN 1092-2

ND	D mm	c mm	g mm	Holes nb x mm
40	150	110	88	4 x 19
50	165	125	102	4 x 19
65	185	145	122	4 x 19
80	200	160	138	8 x 19

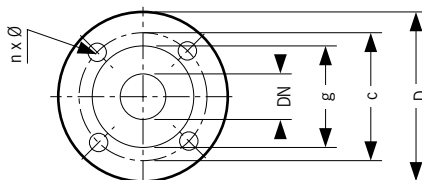

DIFFERENTIAL PRESSURE MONITORING KIT



– Easy, non welded, connection on to the apertures fitted onto the flanges.

Kit including:

- a 0-6 or 0-16 bar glycerin bath pressure gauge
- isolating valves, fittings and linkage piping,
- purger.

Supplied in a pouch with fitting instructions.

Order ref.: **KIT PRESS 6**, or **KIT PRESS 16**

FEATURES

a) Electrical

- SXS 40-40M : 1 ~ 230 V 50 Hz
- 3 ~ 230 or 400 V (dual voltage motor) 50 Hz
- Discontactor motor protection compulsory
- Terminal box connection by cable gland, right or left hand.

b) Installation

- Direct on piping
- Motor shaft always horizontal
- Connection with the facility by means of welded round counter-flanges (not supplied).

c) Packaging

- Supplied packaged with gaskets and nuts, without counter-flanges.

d) Maintenance

- Full exchange of the unit or motor block.

RECOMMENDED...

... ACCESSORIES

- Motor protection by discontactor
- Check valve
- Isolating valve
- Pressure monitoring kit
- Anti-vibration sleeves
- Weld-on round counter-flanges.